

NOTICE!!

These documents have been scanned!

Do not place un-scanned documents beneath this notice!

Do not remove this notice from this file!

GPO Jacket No. 560-102
Print Order 61540
Rise Business Services, LLC
Job=AZ15 5/21/2019



Box Number= AZ15075



Claim Begin-End: AMC452804-AMC452808

1 Initial Receipt

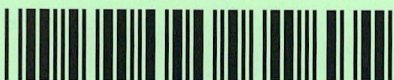

AZ15075-40

AMC452444-AMC452831

United States Department of the Interior
Bureau of Land Management
 DIV OF LANDS, MINRLS & ENERGY
 ONE N CENTRAL AVE
 PHOENIX, AZ 85004 -4427
 Phone: 602-417-9200

Receipt

No: 4355642

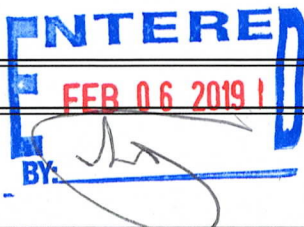
Transaction #: 4472589	
Date of Transaction: 01/29/2019	
CUSTOMER:	
CARROLL MARCUS PO BOX 3054 SKOWHEGAN, ME 04976-3054 US	

LINE #	QTY	DESCRIPTION	REMARKS	UNIT PRICE	TOTAL
1	5.00	LOCATABLE MINERALS / MINING CLAIMS-NEW, UNADJUD, ONE OR MORE AUTH NOS / NEW MINING CLAIM PROCESSING FEE CASES: AMC452804/\$20.00, AMC452805/\$20.00, AMC452806/\$20.00, AMC452807/\$20.00, AMC452808/\$20.00		- n/a -	100.00
2	5.00	LOCATABLE MINERALS / MINING CLAIMS-NEW, UNADJUD, ONE OR MORE AUTH NOS / NEW MINING CLAIMS LOCATION FEE CASES: AMC452804/\$37.00, AMC452805/\$37.00, AMC452806/\$37.00, AMC452807/\$37.00, AMC452808/\$37.00		- n/a -	185.00
3	5.00	LOCATABLE MINERALS / MINING CLAIMS-NEW, UNADJUD, ONE OR MORE AUTH NOS / NEW MINING CLAIMS MAINTENANCE FEE CASES: AMC452804/\$155.00, AMC452805/\$155.00, AMC452806/\$155.00, AMC452807/\$155.00, AMC452808/\$155.00		- n/a -	775.00
TOTAL:					\$1,060.00

PAYMENT INFORMATION			
1	AMOUNT:	1060.00	POSTMARKED: N/A
	TYPE:	CHECK	RECEIVED: 01/28/2019
	CHECK NO:	3589	
	NAME:	MARCUS, CARROLL PO BOX 3054 SKOWHEGAN ME 04976-3054 US	

REMARKS

This receipt was generated by the automated BLM Collections and Billing System and is a paper representation of a portion of the official electronic record contained therein.

NOTICE!!

These documents have been scanned!

Do not place un-scanned documents beneath this notice!

Do not remove this notice from this file!

GPO Jacket No. 560-102
Print Order 61540
Rise Business Services, LLC
Job=AZ15 5/21/2019



Box Number= AZ15075



Claim Begin-End: AMC452804-AMC452808

2 Correspondence



AZ15075-40

AMC452444-AMC452831

**NO
DOCUMENTS
FOUND**

NO DOCUMENTS FOUND
NO DOCUMENTS FOUND

NOTICE!!

These documents have been scanned!

Do not place un-scanned documents beneath this notice!

Do not remove this notice from this file!

GPO Jacket No. 560-102
Print Order 61540
Rise Business Services, LLC
Job=AZ15 5/21/2019



Box Number= AZ15075



Claim Begin-End: AMC452804-AMC452808

3 Transfers



AZ15075-40

AMC452444-AMC452831

**NO
DOCUMENTS
FOUND**

NO DOCUMENTS FOUND
NO DOCUMENTS FOUND

NOTICE!!

These documents have been scanned!

Do not place un-scanned documents beneath this notice!

Do not remove this notice from this file!

GPO Jacket No. 560-102
Print Order 61540
Rise Business Services, LLC
Job=AZ15 5/21/2019



Box Number= AZ15075



Claim Begin-End: AMC452804-AMC452808

4 Annual Filings



AZ15075-40

AMC452444-AMC452831

452 804

UNITED STATES
DEPARTMENT OF THE INTERIOR
BUREAU OF LAND MANAGEMENT
**MAINTENANCE FEE PAYMENT FORM FOR
LODE CLAIMS, MILL SITES, AND TUNNEL SITES**

Remitter Name: Carroll Marcus/ Vaughn Wentworth

Mailing Address: P. O Box 3054

City, State, Zip: Skowhegan, ME 04976

Check here if this is a change of address.

FOR COUNTY RECORDER'S USE

No. of claims/sites 5
x \$~~16~~65 per claim/site
Total due BLM \$ \$825.00

- The maintenance fee may be paid by cash, check, money order, Bureau of Land Management (BLM) Declining Deposit Account, or credit card (VISA, American Express, Discover, or MasterCard). Payments must be remitted to the BLM State Office where your claim or site is recorded and received on or before September 1. If the payment is mailed, the envelope must be postmarked by a bona fide delivery service on or before September 1 and received at the proper BLM State Office within 15 calendar days after the due date. Payments may also be made by telephone using a credit card. A complete listing of BLM State Offices with their addresses and phone numbers can be found at <http://www.blm.gov>.
- The maintenance fee for the following claim(s)/site(s) applies to the assessment year 2020.

CLAIM/SITE NAME	BLM SERIAL NO.
Copper Bottom #12	AMC452804
Copper Bottom #13	AMC452805
Copper Bottom #14	AMC452806
Copper Bottom #15	AMC452807
Copper Bottom #16	AMC452808

RECEIVED
BLM AZ STATE OFFICE
PHOENIX, ARIZONA
2019 AUG 19 P 2:44

Use a separate sheet for additional claim/site names, serial numbers, and claimant names and addresses.

(Continued on page 2)

ENTERED
AUG 21 2019
BY: *[Signature]*

United States Department of the Interior
Bureau of Land Management
 DIV OF LANDS, MINRLS & ENERGY
 ONE N CENTRAL AVE
 PHOENIX, AZ 85004 -4427
 Phone: 602-417-9200

Receipt	
No:	4537795

Transaction #: 4658716
Date of Transaction: 08/20/2019

CUSTOMER:	
VAUGHN A WENTWORTH PO BOX 3054 SKOWHEGAN,ME 04976-3054 US	

LINE #	QTY	DESCRIPTION	REMARKS	UNIT PRICE	TOTAL
1	1.00	LOCATABLE MINERALS / MINING CLAIMS- NOT NEW-UNADJUD,ONE AUTH NO. ONLY / MINING CLAIM MONEY RECEIVED CASES: AMC452804/\$825.00	2020 MAINT/5	- n/a -	825.00
TOTAL:					\$825.00

PAYMENT INFORMATION			
NOTE: Items will appear on credit card statement as "Bureau of Land Mgmt CO".			
1	AMOUNT:	825.00	POSTMARKED: N/A
	TYPE:	CREDIT CARD	RECEIVED: 08/20/2019
	NAME:	WENTWORTH, VAUGHN A PO BOX 3054 SKOWHEGAN ME 04976-3054 US	
	CARD NO:	XXXXXXXXXXXX5301	AUTH CODE: 02097B
	NAME ON CARD:	GEORGEANNE WENTWORTH	
	SIGNATURE:	OVER THE PHONE	

REMARKS

This receipt was generated by the automated BLM Collections and Billing System and is a paper representation of a portion of the official electronic record contained therein.

NOTICE!!

These documents have been scanned!

Do not place un-scanned documents beneath this notice!

Do not remove this notice from this file!

GPO Jacket No. 560-102
Print Order 61540
Rise Business Services, LLC
Job=AZ15 5/21/2019



Box Number= AZ15075



Claim Begin-End: AMC452804-AMC452808

5 Miscellaneous



AZ15075-40

AMC452444-AMC452831

**NO
DOCUMENTS
FOUND**

NO DOCUMENTS FOUND
NO DOCUMENTS FOUND

NOTICE!!

These documents have been scanned!

Do not place un-scanned documents beneath this notice!

Do not remove this notice from this file!

GPO Jacket No. 560-102
Print Order 61540
Rise Business Services, LLC
Job=AZ15 5/21/2019



Box Number= AZ15075



Claim Begin-End: AMC452804-AMC452808

6 Location Notices-Amendments and Supporting Documents



AZ15075-40

AMC452444-AMC452831

MINING CLAIM STATUS REPORT

Data Entered: 2/6/2019

MTP Checked By: _____

GEO Checked By: _____

LEAD SERIAL NUMBER: AMC 452804 thru AMC 452808

NUMBER OF CLAIMS & TYPE:

5 LODE
 _____ PLACER
 _____ ASSOCIATION PLACER
 _____ MILL SITE
 _____ TUNNEL SITE

CHARGES:

Processing Fee @ \$20 = \$ 100
 Location Fee @ \$37 = \$ 185
 Maintenance Fee @ \$155 = \$ 775
 Add'l Maint Fee for Assoc Placer = \$ _____
SUBTOTAL \$ _____
 Other Fees \$ _____
 Other Fees \$ _____
TOTAL \$ 1,060

TOTAL ACREAGE: _____ Per Claim
(Placer Only)

NUMBER OF LOCATORS: _____

DOCUMENTS RECEIVED VIA: Over-the-Counter [] Mail [] TIMELY FILED: Yes [] No []

LEGAL DESCRIPTION: T 3N R 20W SEC 28, 29
 T _____ R _____ SEC _____
 T _____ R _____ SEC _____
 T _____ R _____ SEC _____
 T _____ R _____ SEC _____

BLM [] FOREST SERVICE [] WILDERNESS AREA [] SUBJ TO PL 359: Yes [] No []

SPLIT ESTATE: N/A [] SX [] PX [] OTHER [] SRHA [] Was proper Notice filed if located on SHRA Land? Yes [] No []

RECONVEYED MINERALS ON BLM LAND REQUIRE OPENING ORDER FROM 1944 TO 1993:
Open to Entry On _____ N/A []

COMMENTS/STATUS: VOID [] PARTIALLY VOID [] PVT MINERALS [] WITHDRAWN LANDS []
OTHER []

AMC452804

[] Claimant acknowledges that portions of the following claim(s) site(s) may be void or voidable.

Printed Name of Claimant _____ Signature of Claimant _____

*****FINAL ADJUDICATION*****

DATE _____ INITIALS _____

MAP OF MINING CLAIM LOCATION

- The name of the claim is Copper Bottom #12
- Type of claim is Placer Lode Millsite Tunnel-site Check one only
- The NW corner of the claim is 0 feet in a (AT) direction to a survey monument or permanent natural object described as Copper Bottom #9 SW Corner US Mining Survey #1876 Patent
- The bearing and distance between the corners of the claim are beginning at the NW corner of the claim, 600 feet in a NE direction to the NE corner, then 1500 feet in a SE direction to the SE corner, then 600 feet in SW direction to the SW corner, then 1500 feet in a NW to the point of beginning.

MAP

One inch = Two thousand feet

North arrow

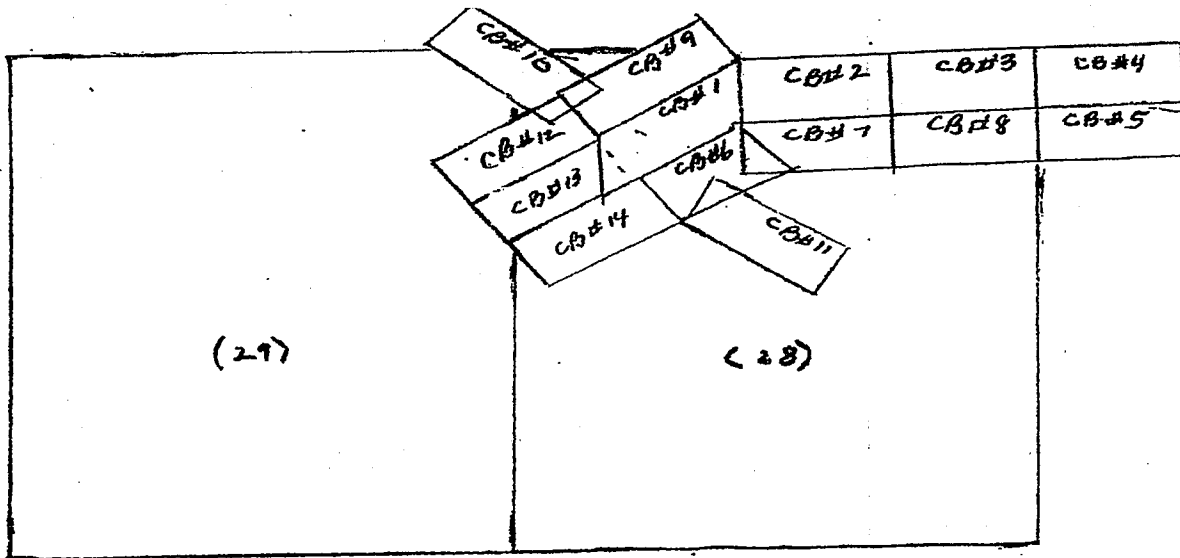

Section 29-28 Township 3N Range 20W G & SRB & M

Date 12-17-18

Carol A. Maren
 Signature
Carol A. Maren

Recorded at the Request of:

When recorded mail to:

Vaughn Wentworth
 P.O. Box 3054
 Skowhegan, ME 04976

RECEIVED
 BLM AZ STATE OFFICE
 2018 DEC 20 P 1:14
 PHOENIX, ARIZONA

NOTICE OF MINING CLAIM LOCATION

1. Location Amendment Check one only
2. Placer Lode Millsite Tunnelsite Check one only
3. The name and address of the Locator is Carroll Marcus + Vaughn Wentworth

<u>P.O. Box 3054</u>	<u>Skowhegan</u>	<small>Name</small>	<u>ME 04976</u>
<small>Address</small>	<small>City</small>	<small>State</small>	<small>Zip</small>
4. The name of the claim is Copper Bottom #13
5. The date of the location is 3-21-08
6. The type of location monument is 5/8" rebar with 1/4" lath + 1 1/2" dia. long 4' PVC Pipe
7. The type of corner and end monument is Same as location monument
8. The claim is 1500 feet long and 600 feet wide. The Distance from the location monument to each end of the claim is 300 feet in a Northern direction and 300 feet in a Southern direction.
9. The general course is from the NE to the SW.

10. The location of the claim occupies all or part of the following quarter sections:

Quarter Section(s)	Section(s)	Township(s)	Range(s)
<u>NW 1/4</u>	<u>28</u>	<u>3N</u>	<u>20W</u>
<u>NE 1/4</u>	<u>29</u>	<u>3N</u>	<u>20W</u>

11. The locality of this claim with reference to some natural object or permanent monument and additional information (if any) concerning its locality are as follows:
 The northwest corner of this claim, being called the NW corner monument is found 0 feet in an (AT) direction from the SW corner monument for CB #1 Lode which is part of the US Mineral Survey #1876 Patent. The southern most corner monument of the CB #1 Lode is referred to as the SE corner of the CB #1 herein.
12. If amending, the previous claim name was _____ recorded in Docket _____ Book _____ Mining District _____ County, Arizona.

Date 12-17-18
 Signature Carroll A. Marcus
Vaughn A. Wentworth

AMC452805

MAP OF MINING CLAIM LOCATION

- The name of the claim is Copper Bottom #13
- Type of claim is Placer Lode Millsite Tunnel site **Check one only**
- The NW corner of the claim is 0 feet in a At direction to a survey monument or permanent natural object described as Copper Bottom #1 SW Corner US Mining Survey #1876 Patent
- The bearing and distance between the corners of the claim are beginning at the NW corner of the claim, 600 feet in a NE direction to the NE corner, then 1500 feet in a SE direction to the SE corner, then 600 feet in a SW direction to the SW corner, then 1500 feet in a NW to the point of beginning.

MAP

One inch = Two thousand feet

North arrow

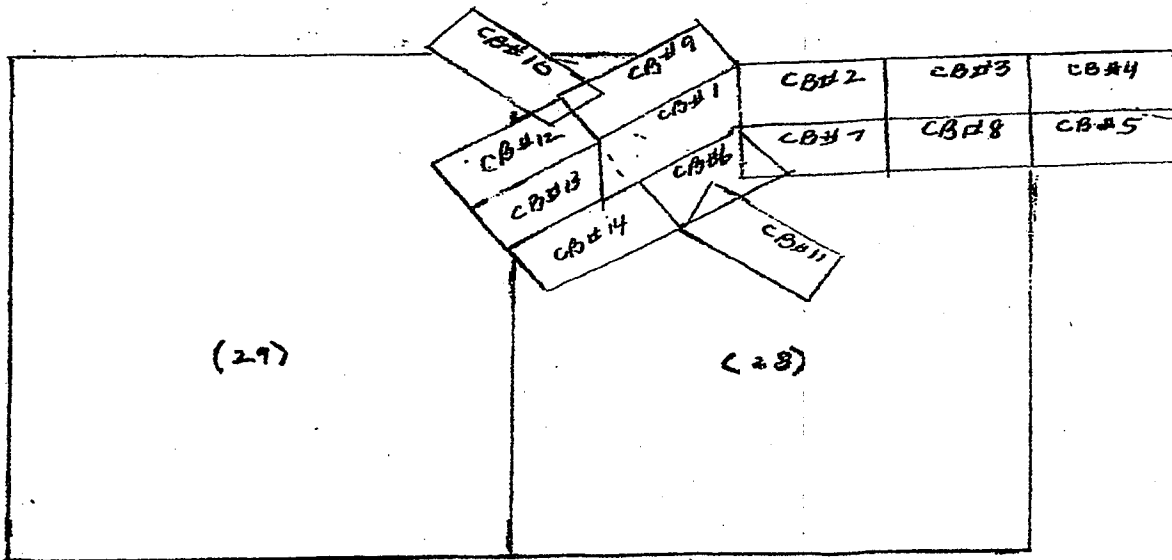

Section 29+28 Township 3N Range 20W G & SRB & M

Date 12-17-18

Arnold A. Marx
 Signature
Naught A. Waterbury

RECEIVED
 BLM AZ STATE OFFICE

2018 DEC 20 P 1:44
 PHOENIX, ARIZONA

Recorded at the Request of:

When recorded mail to:

Vaughn Wentworth
 P.O. Box 3054
 Skowhegan, ME 04976

NOTICE OF MINING CLAIM LOCATION

- Location Amendment *Check one only*
- Placer Lode Millsite Tunnelsite *Check one only*
- The name and address of the Locator is Carroll Marcus + Vaughn Wentworth
P.O. Box 3054 Skowhegan ME 04976
Name
Address City State Zip
- The name of the claim is Copper Bottom #14
- The date of the location is 3-21-08
- The type of location monument is 5/8" rebar with 4' lath + 1/2" dia 4' long PVC pipe
- The type of corner and end monument is Same as Location Monument
- The claim is 1500 feet long and 600 feet wide. The Distance from the location monument to each end of the claim is 300 feet in a Northern direction and 300 feet in a Southern direction.
- The general course is from the NE to the SW

10. The location of the claim occupies all or part of the following quarter sections:

Quarter Section(s)	Section(s)	Township(s)	Range(s)
<u>NW 1/4</u>	<u>28</u>	<u>3N</u>	<u>20W</u>
<u>NE 1/4</u>	<u>29</u>	<u>3N</u>	<u>20W</u>

11. The locality of this claim with reference to some natural object or permanent monument and additional information (if any) concerning its locality are as follows:

The northwest corner of this claim, being called the NW corner monument is found 0 feet in an (AT) direction from the SW corner monument for CB#6 Lode which is part of the US Mineral Survey #1876 Patent. The southern most corner monument of the CB #6 Lode is referred to as the SE corner of the CB #6 herein.

12. If amending, the previous claim name was _____ recorded in Docket _____, Book _____ Mining District _____ County, Arizona.

Date 12-17-18

Carroll A. Marc
 Signature
Vaughn A. Wentworth

AMC452806

MAP OF MINING CLAIM LOCATION

- The name of the claim is Copper Bottom #14
- Type of claim is Placer Lode Millsite Tunnel site Check one only
- The NW corner of the claim is 0 feet in a AT direction to a survey monument or permanent natural object described as CB #6 SW Corner US Mining Survey #1876 Patent
- The bearing and distance between the corners of the claim are beginning at the NW corner of the claim, 600 feet in a NE direction to the NE corner, then 1500 feet in a SE direction to the SE corner, then 600 feet in a SW direction to the SW corner, then 1500 feet in a NW to the point of beginning.

MAP

One inch = Two thousand feet

North arrow

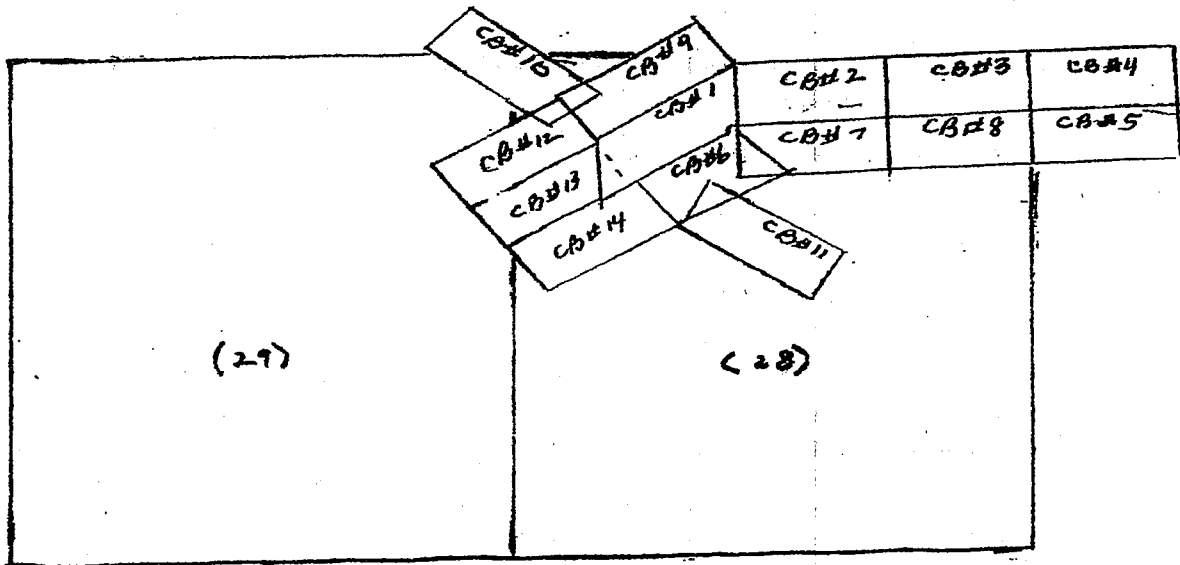

Section 29+28 Township 3N Range 20W G & SRB & M
 Date 12-17-18
 Signature David A. Moore
David A. Moore

04657

Recorded at the Request of:

When recorded mail to:

Vaughn Wentworth
PO Box 3054
Skowhegan ME 04976

RECEIVED
BLM AZ STAFF OFFICE
2018 DEC 20 P 1:44
PHOENIX, ARIZONA

NOTICE OF MINING CLAIM LOCATION

- 1. Location Amendment Check one only
- 2. Placer Lode Millsite Tunnelsite Check one only
- 3. The name and address of the Locator is Carroll Marcus + Vaughn Wentworth
Name
P.O. Box 3054 Skowhegan ME 04976
Address City State Zip
- 4. The name of the claim is Copper Bottom 15
- 5. The date of the location is 4-5-08
- 6. The type of location monument is 5/8" Rebar with 4' lath + 1 1/2" dia. long 4' PVC Pipe
- 7. The type of corner and end monument is Same as Location Monument
- 8. The claim is 1500 feet long and 600 feet wide. The Distance from the location monument to each end of the claim is 300 feet in a Northern direction and 300 feet in a Southern direction.
- 9. The general course is from the NE to the SW.

10. The location of the claim occupies all or part of the following quarter sections:

Quarter Section(s)	Section(s)	Township(s)	Range(s)
<u>NW 1/4</u>	<u>28</u>	<u>3N</u>	<u>20W</u>

11. The locality of this claim with reference to some natural object or permanent monument and additional information (if any) concerning its locality are as follows:
 The location monument for CB#15 is 300 feet from the NW corner of said claim in a southeasterly direction and is located at the SW corner monument for CB#11 Lode which is part of the US Mineral Survey #1876 Patent. The southern most corner monument of the CB #11 Lode is referred to as the SE corner of the CB #11 herein.

12. If amending, the previous claim name was _____ recorded in Docket _____, Book _____, Mining District _____, _____ County, Arizona.

Date 12-17-18
 Signature Carroll A. Marcus
Vaughn A. Wentworth

AMC452807

MAP OF MINING CLAIM LOCATION

- The name of the claim is Copper Bottom #15
- Type of claim is Placer Lode Millsite Tunnel site Check one only
- The NW corner of the claim is 300 feet in a SE direction to a survey monument or permanent natural object described as CB #11 SW Corner U.S. Mining Survey #1876 Patent
- The bearing and distance between the corners of the claim are beginning at the NW corner of the claim, 600 feet in a NE direction to the NE corner, then 1500 feet in a SE direction to the SE corner, then 600 feet in a SW direction to the SW corner, then 1500 feet in a NW to the point of beginning.

MAP

One inch = Two thousand feet

North arrow

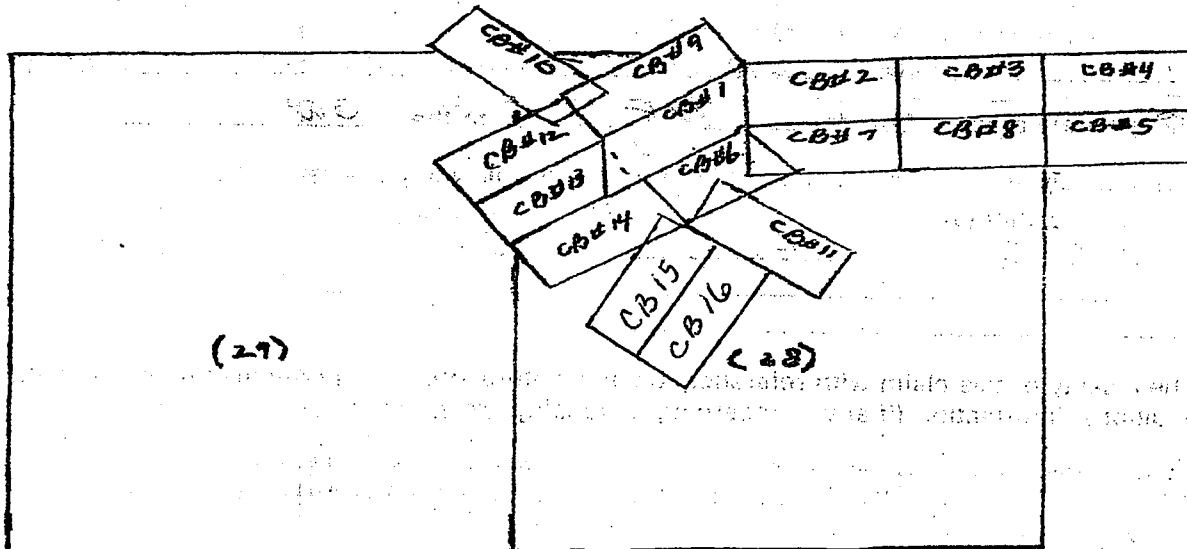

Section 28 Township 3N Range 20W G & SRB & M

Date 12-17-18

Carroll A. Mares
 Signature
Naugher

MAP OF MINING CLAIM LOCATION

- The name of the claim is Copper Bottom #16
- Type of claim is Placer Lode Millsite Tunnel site Check one only
- The NW corner of the claim is 300 feet in a Southeast direction to a survey monument or permanent natural object described as Copper Bottom #11 SW corner U.S. Mining Survey #1876 Patent
- The bearing and distance between the corners of the claim are beginning at the NW corner of the claim, 600 feet in a NE direction to the NE corner, then 1500 feet in a SE direction to the SE corner, then 600 feet in a SW direction to the SW corner, then 1500 feet in a NW to the point of beginning.

MAP

One inch = Two thousand feet

North arrow

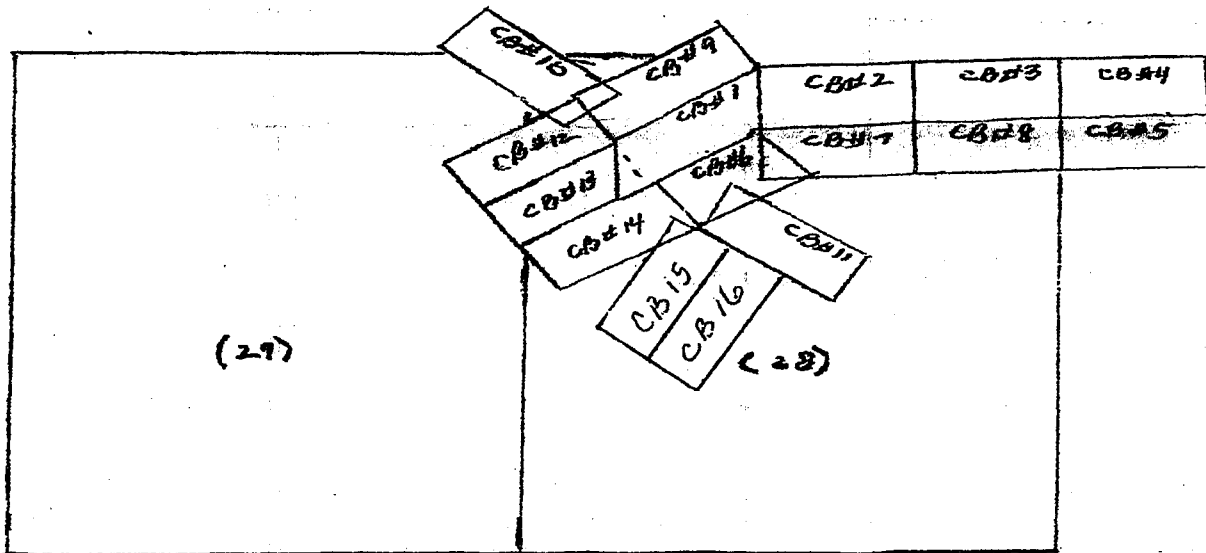

Section 28 Township 3N Range 20W G & SRB & M

Date 12-17-18

Carroll A. Ware
Signature
Vanessa A. W. Ware

**DEPARTMENT OF THE INTERIOR
BUREAU OF LAND MANAGEMENT
Case Recordation**

Geographic Report with Land

Meridian Township Range Section is equal to **14 0030N 0200W 028 , 14 0030N 0200W
029**
and Admin State is equal to **AZ**

DEPARTMENT OF THE INTERIOR
BUREAU OF LAND MANAGEMENT
Case Recordation
Geographic Report with Land

Admin State: AZ
Geo State: AZ
Serial Number: AZA 004339

Total Case Acres: 153.430

Casetype	Case Disp	Mer	Twp	Rng	Sec	Sur Type	Sur Nr	Suf	Subdivision	Pending Action
288100	AUTHORIZED	14	0030N	0200W	028	PROT		1	S2NW,S2;	Y
					029	PROT		1	NE;	Y

Admin State: AZ
Geo State: AZ
Serial Number: AZA 005308

Total Case Acres: 0.021

Casetype	Case Disp	Mer	Twp	Rng	Sec	Sur Type	Sur Nr	Suf	Subdivision	Pending Action
286005	CLOSED	14	0030N	0200W	029	PROT		1	SW;	

Admin State: AZ
Geo State: AZ
Serial Number: AZA 006487

Total Case Acres: 16.784

Casetype	Case Disp	Mer	Twp	Rng	Sec	Sur Type	Sur Nr	Suf	Subdivision	Pending Action
286001	AUTHORIZED	14	0030N	0200W	028	PROT			S2;	Y
					029	PROT		1	E2SW,S2SE;	Y

Admin State: AZ
Geo State: AZ
Serial Number: AZA 006487A

Total Case Acres: 0.010

Casetype	Case Disp	Mer	Twp	Rng	Sec	Sur Type	Sur Nr	Suf	Subdivision	Pending Action
286007	CLOSED	14	0030N	0200W	029	PROT			SW;	

Admin State: AZ
Geo State: AZ
Serial Number: AZA 006692

Total Case Acres: 5.600

Casetype	Case Disp	Mer	Twp	Rng	Sec	Sur Type	Sur Nr	Suf	Subdivision	Pending Action
286005	CLOSED	14	0030N	0200W	028	PROT			W2SW;	
					029	PROT			SW,S2SE;	

Admin State: AZ
Geo State: AZ
Serial Number: AZA 006692A

Total Case Acres: 55.001

DEPARTMENT OF THE INTERIOR
BUREAU OF LAND MANAGEMENT
Case Recordation

Casetype	Case Disp	Mer	Twp	Rng	Sec	Sur Type	Sur Nr	Suf	Subdivision	Pending Action
286001	CLOSED	14	0030N	0200W	029	PROT		1	NESW;	

Admin State: AZ
Geo State: AZ
Serial Number: AZA 007556

Total Case Acres: 0.005

Casetype	Case Disp	Mer	Twp	Rng	Sec	Sur Type	Sur Nr	Suf	Subdivision	Pending Action
286007	CLOSED	14	0030N	0200W	029	PROT		1	SW;	

Admin State: AZ
Geo State: AZ
Serial Number: AZA 00755601

Total Case Acres: 0.003

Casetype	Case Disp	Mer	Twp	Rng	Sec	Sur Type	Sur Nr	Suf	Subdivision	Pending Action
286009	CLOSED	14	0030N	0200W	029	FF		1	SW;	

Admin State: AZ
Geo State: AZ
Serial Number: AZA 007556A

Total Case Acres: 0.001

Casetype	Case Disp	Mer	Twp	Rng	Sec	Sur Type	Sur Nr	Suf	Subdivision	Pending Action
286007	CLOSED	14	0030N	0200W	029	PROT		1	NESW;	

Admin State: AZ
Geo State: AZ
Serial Number: AZA 008037

Total Case Acres: 15.995

Casetype	Case Disp	Mer	Twp	Rng	Sec	Sur Type	Sur Nr	Suf	Subdivision	Pending Action
286001	AUTHORIZED	14	0030N	0200W	029	PROT		1	SW;	Y

Admin State: AZ
Geo State: AZ
Serial Number: AZA 008483

Total Case Acres: 0.010

Casetype	Case Disp	Mer	Twp	Rng	Sec	Sur Type	Sur Nr	Suf	Subdivision	Pending Action
286005	CLOSED	14	0030N	0200W	029	PROT		1	SW;	

Admin State: AZ
Geo State: AZ
Serial Number: AZA 009141

Total Case Acres: 0.062

Casetype	Case Disp	Mer	Twp	Rng	Sec	Sur Type	Sur Nr	Suf	Subdivision	Pending Action
286005	CLOSED	14	0030N	0200W	029	FF		1	SW;	

Admin State: AZ

DEPARTMENT OF THE INTERIOR
BUREAU OF LAND MANAGEMENT
Case Recordation

Geo State: AZ
Serial Number: AZA 009878

Total Case Acres: 1,339.520

Casetype	Case Disp	Mer	Twp	Rng	Sec	Sur Type	Sur Nr	Suf	Subdivision	Pending Action
285003	AUTHORIZED	14	0030N	0200W	028	FF		1	NW,S2;	
					029	FF		1	N2;	

Admin State: AZ
Geo State: AZ
Serial Number: AZA 015484

Total Case Acres: 0.010

Casetype	Case Disp	Mer	Twp	Rng	Sec	Sur Type	Sur Nr	Suf	Subdivision	Pending Action
286001	CLOSED	14	0030N	0200W	029	PROT		1	SWSW;	

Admin State: AZ
Geo State: AZ
Serial Number: AZA 022599

Total Case Acres: 64.280

Casetype	Case Disp	Mer	Twp	Rng	Sec	Sur Type	Sur Nr	Suf	Subdivision	Pending Action
281001	CLOSED	14	0030N	0200W	028	PROT		1	E2;	
					029	PROT		1	NE;	

Admin State: AZ
Geo State: AZ
Serial Number: AZA 023805

Total Case Acres: 1,339.520

Casetype	Case Disp	Mer	Twp	Rng	Sec	Sur Type	Sur Nr	Suf	Subdivision	Pending Action
285003	AUTHORIZED	14	0030N	0200W	028	ALIQ			NW,S2;	
					029	ALIQ			N2;	

Admin State: AZ
Geo State: AZ
Serial Number: AZA 025151

Total Case Acres: 0.062

Casetype	Case Disp	Mer	Twp	Rng	Sec	Sur Type	Sur Nr	Suf	Subdivision	Pending Action
286001	CLOSED	14	0030N	0200W	029	ALIQ			SW;	

Admin State: AZ
Geo State: AZ
Serial Number: AZA 027308

Total Case Acres: 1.000

Casetype	Case Disp	Mer	Twp	Rng	Sec	Sur Type	Sur Nr	Suf	Subdivision	Pending Action
286007	CLOSED	14	0030N	0200W	029	FF		1	E2SW;	

Admin State: AZ
Geo State: AZ
Serial Number: AZA 027405

DEPARTMENT OF THE INTERIOR
BUREAU OF LAND MANAGEMENT
Case Recordation

Total Case Acres: 1.000

Casetype	Case Disp	Mer	Twp	Rng	Sec	Sur Type	Sur Nr	Suf	Subdivision	Pending Action
286007	CLOSED	14	0030N	0200W	029	FF		1	SW;	

Admin State: AZ
Geo State: AZ
Serial Number: AZA 028841

Total Case Acres: 0.026

Casetype	Case Disp	Mer	Twp	Rng	Sec	Sur Type	Sur Nr	Suf	Subdivision	Pending Action
286001	AUTHORIZED	14	0030N	0200W	029	FF		1	PROT SW;	

Admin State: AZ
Geo State: AZ
Serial Number: AZA 030302

Total Case Acres: 16.088

Casetype	Case Disp	Mer	Twp	Rng	Sec	Sur Type	Sur Nr	Suf	Subdivision	Pending Action
286001	AUTHORIZED	14	0030N	0200W	028	ALIQ			S2;	Y
					029	ALIQ			E2SW;	Y

Admin State: AZ
Geo State: AZ
Serial Number: AZA 03030201

Total Case Acres: 0.500

Casetype	Case Disp	Mer	Twp	Rng	Sec	Sur Type	Sur Nr	Suf	Subdivision	Pending Action
286009	CLOSED	14	0030N	0200W	029	MNR		1	NWSESW;	

Admin State: AZ
Geo State: AZ
Serial Number: AZA 030557

Total Case Acres: 1.000

Casetype	Case Disp	Mer	Twp	Rng	Sec	Sur Type	Sur Nr	Suf	Subdivision	Pending Action
286007	CLOSED	14	0030N	0200W	029	FF		1	E2SW;	

Admin State: AZ
Geo State: AZ
Serial Number: AZA 031014

Total Case Acres: 16.138

Casetype	Case Disp	Mer	Twp	Rng	Sec	Sur Type	Sur Nr	Suf	Subdivision	Pending Action
286001	AUTHORIZED	14	0030N	0200W	028	ALIQ			S2;	Y
					029	ALIQ			E2SW,S2SE;	Y

Admin State: AZ
Geo State: AZ

DEPARTMENT OF THE INTERIOR
BUREAU OF LAND MANAGEMENT
Case Recordation

Serial Number: AZA 03101401

Total Case Acres: 0.275

Casetype	Case Disp	Mer	Twp	Rng	Sec	Sur Type	Sur Nr	Suf	Subdivision	Pending Action
280004	CLOSED	14	0030N	0200W	028	PROT			NWNESW;	
					029	PROT			SWNESW;	

Admin State: AZ
Geo State: AZ
Serial Number: AZA 03107402

Total Case Acres: 1.000

Casetype	Case Disp	Mer	Twp	Rng	Sec	Sur Type	Sur Nr	Suf	Subdivision	Pending Action
286203	CLOSED	14	0030N	0200W	028	ALIQ			NESW,NWSW,NWSE, SWSE,SESE;	
					029	ALIQ			SWNW; NENE,NWNE,SESE;	

Admin State: AZ
Geo State: AZ
Serial Number: AZA 03107403

Total Case Acres: 1.000

Casetype	Case Disp	Mer	Twp	Rng	Sec	Sur Type	Sur Nr	Suf	Subdivision	Pending Action
280004	CLOSED	14	0030N	0200W	028	ALIQ			NESW,NWSW,NWSE, SWSE,SESE;	
					029	ALIQ			SWNW; NENE,NWNE,SESE;	

Admin State: AZ
Geo State: AZ
Serial Number: AZA 032361

Total Case Acres: 21.130

Casetype	Case Disp	Mer	Twp	Rng	Sec	Sur Type	Sur Nr	Suf	Subdivision	Pending Action
286001	AUTHORIZED	14	0030N	0200W	028	ALIQ			W2SW;	Y
					029	ALIQ			SW,S2SE;	Y

Admin State: AZ
Geo State: AZ
Serial Number: AZA 034515

Total Case Acres: 15.970

Casetype	Case Disp	Mer	Twp	Rng	Sec	Sur Type	Sur Nr	Suf	Subdivision	Pending Action
286001	AUTHORIZED	14	0030N	0200W	029	ALIQ			SW;	

Admin State: AZ
Geo State: AZ
Serial Number: AZA 035195

Total Case Acres: 1.000

DEPARTMENT OF THE INTERIOR
BUREAU OF LAND MANAGEMENT
Case Recordation

Casetype	Case Disp	Mer	Twp	Rng	Sec	Sur Type	Sur Nr	Suf	Subdivision	Pending Action
286001	AUTHORIZED	14	0030N	0200W	029	ALIQ			E2SW;	

Admin State: AZ
Geo State: AZ
Serial Number: AZA 035537

Total Case Acres: 1.000

Casetype	Case Disp	Mer	Twp	Rng	Sec	Sur Type	Sur Nr	Suf	Subdivision	Pending Action
286001	PENDING	14	0030N	0200W	029	ALIQ			SW;	Y

Admin State: AZ
Geo State: AZ
Serial Number: AZA 035676

Total Case Acres: 15.970

Casetype	Case Disp	Mer	Twp	Rng	Sec	Sur Type	Sur Nr	Suf	Subdivision	Pending Action
286001	CLOSED	14	0030N	0200W	028	PROT			S2;	
					029	PROT			E2SW,S2SE;	

Admin State: AZ
Geo State: AZ
Serial Number: AZA 035985

Total Case Acres: 15.910

Casetype	Case Disp	Mer	Twp	Rng	Sec	Sur Type	Sur Nr	Suf	Subdivision	Pending Action
286001	AUTHORIZED	14	0030N	0200W	028	ALIQ			S2;	
					029	ALIQ			E2SW;	

Admin State: AZ
Geo State: AZ
Serial Number: AZA 036329

Total Case Acres: 1.000

Casetype	Case Disp	Mer	Twp	Rng	Sec	Sur Type	Sur Nr	Suf	Subdivision	Pending Action
286001	AUTHORIZED	14	0030N	0200W	028	ALIQ			S2;	Y
					029	ALIQ			E2SW;	Y

Admin State: AZ
Geo State: AZ
Serial Number: AZA 036819

Total Case Acres: 1,300.000

Casetype	Case Disp	Mer	Twp	Rng	Sec	Sur Type	Sur Nr	Suf	Subdivision	Pending Action
285003	PENDING	14	0030N	0200W	028	ALIQ			NW,S2;	Y
					029	ALIQ			N2;	Y

Admin State: AZ
Geo State: AZ

DEPARTMENT OF THE INTERIOR
BUREAU OF LAND MANAGEMENT
Case Recordation

Serial Number: AZA 03681901

Total Case Acres: 151.820

Casetype	Case Disp	Mer	Twp	Rng	Sec	Sur Type	Sur Nr	Suf	Subdivision	Pending Action
285003	AUTHORIZED	14	0030N	0200W	028	UNSU			SWNW,SW,NWSE, S2SE;	
					029	UNSU			N2NE,SENE,NENW; SESW,S2SE;	

Admin State: AZ
Geo State: AZ
Serial Number: AZA 037489

Total Case Acres: 1.000

Casetype	Case Disp	Mer	Twp	Rng	Sec	Sur Type	Sur Nr	Suf	Subdivision	Pending Action
280004	CLOSED	14	0030N	0200W	028	ALIQ			NESW;	

Admin State: AZ
Geo State: AZ
Serial Number: AZAR 0014225

Total Case Acres: 5.717

Casetype	Case Disp	Mer	Twp	Rng	Sec	Sur Type	Sur Nr	Suf	Subdivision	Pending Action
286007	CLOSED	14	0030N	0200W	028	PROT		1	SW;	
					029	PROT		1	E2SW,S2SE;	

Admin State: AZ
Geo State: AZ
Serial Number: AZAR 0032619

Total Case Acres: 111.470

Casetype	Case Disp	Mer	Twp	Rng	Sec	Sur Type	Sur Nr	Suf	Subdivision	Pending Action
285003	AUTHORIZED	14	0030N	0200W	028	ALIQ			NESW,SWSW;	Y
						MNR			NWSESW,S2NWSE, N2SWSE;	Y
					029	ALIQ			S2SE,S2NESW;	Y
						MNR			S2NESW,N2SESW;	Y

Admin State: AZ
Geo State: AZ
Serial Number: AZAR 003261901

Total Case Acres: 0.460

Casetype	Case Disp	Mer	Twp	Rng	Sec	Sur Type	Sur Nr	Suf	Subdivision	Pending Action
280004	CLOSED	14	0030N	0200W	028	MNR			NWNESW;	

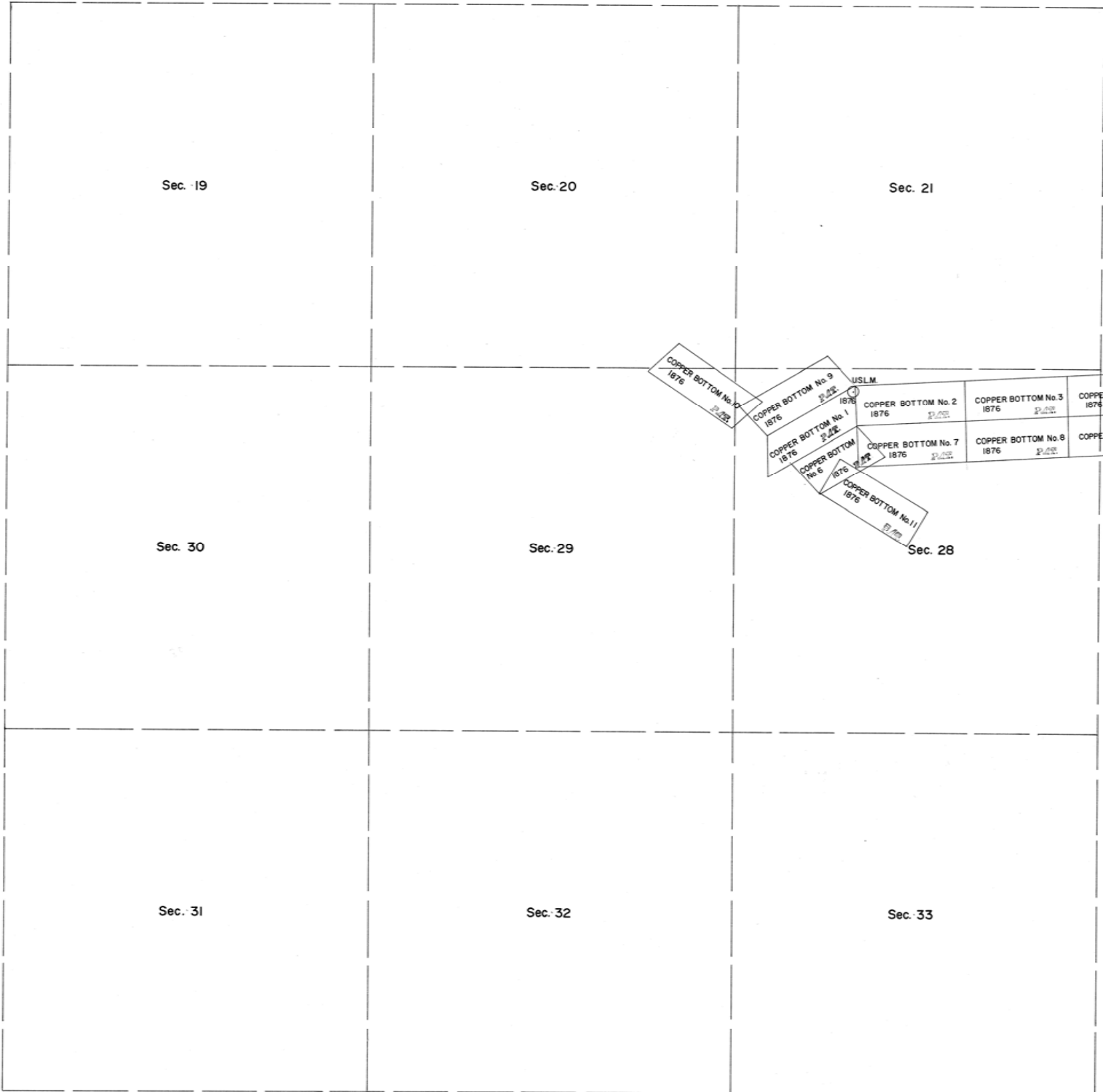

Sec. 19

Sec. 20

Sec. 21

Sec. 30

Sec. 29

Sec. 28

Sec. 31

Sec. 32

Sec. 33

COPPER BOTTOM No. 10
1876
P.M.

COPPER BOTTOM No. 9
1876
P.M.

COPPER BOTTOM No. 1
1876
P.M.

COPPER BOTTOM No. 6
1876
P.M.

COPPER BOTTOM No. 11
1876
U.S.L.M.

U.S.L.M.

COPPER BOTTOM No. 2
1876
P.M.

COPPER BOTTOM No. 3
1876
P.M.

COPPER BOTTOM No. 4
1876
P.M.

COPPER BOTTOM No. 7
1876
P.M.

COPPER BOTTOM No. 8
1876
P.M.

COPPER BOTTOM No. 5
1876
P.M.

Vaughn A. Wentworth
PO Box 3054
Skowhegan, ME 04976



United States Dept of the Interior
Bureau of Land Management
One North Central Avenue
Suite 800

Phoenix, AZ 85004-4427

PHOENIX, ARIZONA

2018 DEC 20 P 1:44

RECEIVED
BLM AZ STATE OFFICE

